



SWITCH ON CO-OPERATION

Car heating and charging units

Satmatic Oy

Co-operation with us - a key to success

Satmatic Oy is one of Finland's leading manufacturers in electric and automation techniques with over 20 years of experience. We have specialised in serial production of standardised cabinets and manufacturing of electrical equipments and switchgears as well as electrification and automation projects.

We have nearly 100 people working in Ulvila and Kerava. The whole corporate group employees approximately 500 professionals.

Our product range includes automation and electric cabinets, electrical switchgears, electromechanical manufacturing and standardised production as well as engineering, - installing, - and maintenance services.

We work both contract- and project based.

With our client relationship we put effort on long-term co-operation. Our goal is success with our customers!

Cost-effectively constituted car heating units fit well as part of our strong logistics chain.

The car heating unit manufactured by Satmatic was previously sold under the brand of Siemens.



Product line



8MMO361

- 2pc earthed sockets
- 2pc RCD residual current device 16 A/30 mA
- SSTL: 3408514
- In picture: Led-light (accessory)



8MMO358

- 2pc earthed sockets
- 2pc circuit breakers 16 A
- 1pc RCD residual current device 30 mA
- Digital clock
- SSTL: 3405065
- In picture: Led-light (accessory)



8MMO368

- 2pc earthed sockets
- 2pc RCD residual current device 16 A/30 mA
- Digital clock
- SSTL: 3405074
- In picture: Led-light (accessory)



8MMO442

- 2pc earthed sockets
- 1pc circuit breaker 16A
- 1pc RCD residual current device 30 mA
- SSTL: 3408511



8MMO452

- 2pc earthed sockets
- 2pc circuit breakers 16 A
- 1pc RCD residual current device 30 mA
- SSTL: 3408512



8MMO459

- 2pc earthed sockets
- 2pc circuit breakers 16 A
- 2pc switch clock with 2h-switching cycle
- 1pc RCD residual current device 30 mA
- SSTL: 3431104
- In picture: Lighted switch clocks (accessory)

See the whole collection on our web-site www.satmatic.fi

All units in 400-series are also available without locks and with models than 200-series.



8MMO469

- 2pc earthed sockets
- 2pc RCD residual current device 16 A/30 mA
- 2pc switch clock with 2h-switching cycle
- SSTL: 3431105
- In picture: Lighted switch clocks (accessory)



8MMO258

- 2pc earthed sockets
- 2pc circuit breakers 16 A
- 2pc switch clock with 2h-switching cycle
- 1pc RCD residual current device 30 mA
- SSTL: 3405048

Car heating and charging unit 458

Car heating and charging unit is equipped with 16A circuit breaker.

Simple yet reliable locking mechanism; the unit can be opened by pushing the hole with car keys etc. Also available with key lock.



Locking mechanism of unit without key lock. (8MMO459)



The unit is impact and frost proof fibreglass coated polycarbonate.

RCD residual current device 30 mA

Plug board (size 5x16mm in every model) is suitable for 3-phase chaining. As the plug board is located on the upper part of the unit the switching space for wires is sufficient.

Switch clock is equipped with 2 hours switching cycle.

Two earthed sockets on every model.

Removing the panel allows an easy access to fasten holes on the bottom. They are needed when installing the unit on to a wall or back to back on the same poll.

Technical details

Short circuit current capacity: $I_{cw} < 10kA$
 Electrical shock protection: Enclosure and earthed system
 Distribution system: TN

EMC operating environment: 1 and 2
 Rated insulation voltage: $U_i = U_e$
 Enclosure class: IP 24

Car heating and charging unit 358



Technical details

Short circuit current capacity:	$I_{cw} < 10\text{kA}$	EMC operating environment:	1 and 2
Electrical shock protection:	Enclosure and earthed system	Rated insulation voltage:	$U_i = U_e$
Distribution system:	TN	Enclosure class:	IP 24

Installing instructions

After wiring the enclosure profile is put on place via grooves on the bottom (see picture arrow 1).

Timing sockets are installed in models with timing clock. Push the timing socket on to the socket base, switch part 0-1 to up left. Finger guard is fastened with two screws to the installing plate (see picture 2).

Models without timing clock the finger guard is fastened on place by installing the centre plate and fastening the screws of the finger plate and centre plate.

To finish put the roof on (see picture arrow 3). When installing cables sufficient protection must be followed in order to prevent damages on wire.

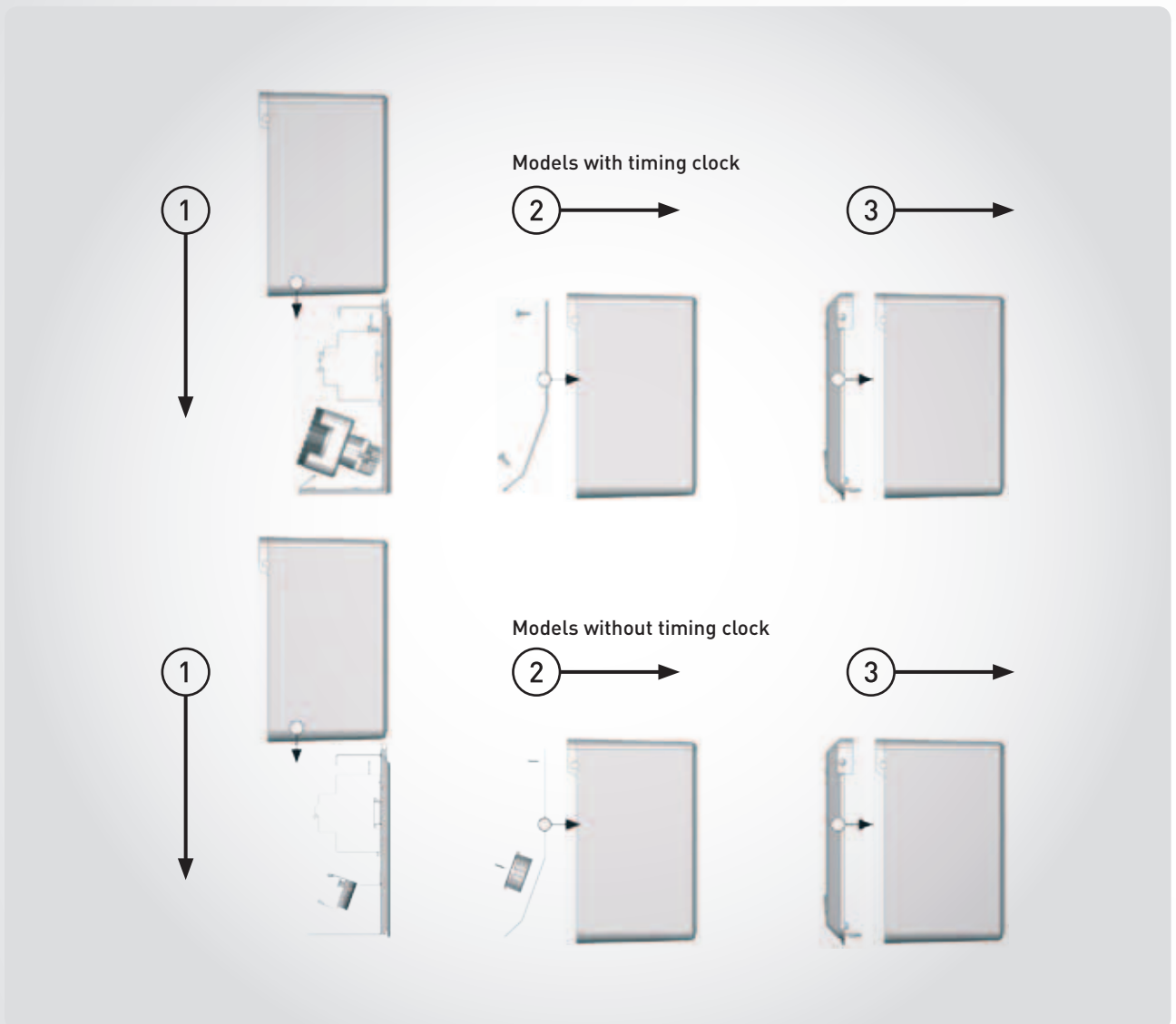

Installing the units back to back

Pole plate is installed similar as with one unit.

When installing units back to back the installation plate has to be removed along with the parts as in individual unit. This can be done by removing rubber knob from the hole of B-plate's fastening screw.

Same inspections as with single units must be done to ensure correct installation of the plate. Follow the instructions of single unit pole installation.

Screw holes M6 are left open and must be closed with screws (2x2 pc) We recommend that units are fastened to each other to prevent bending in result of e.g. heavy cables.

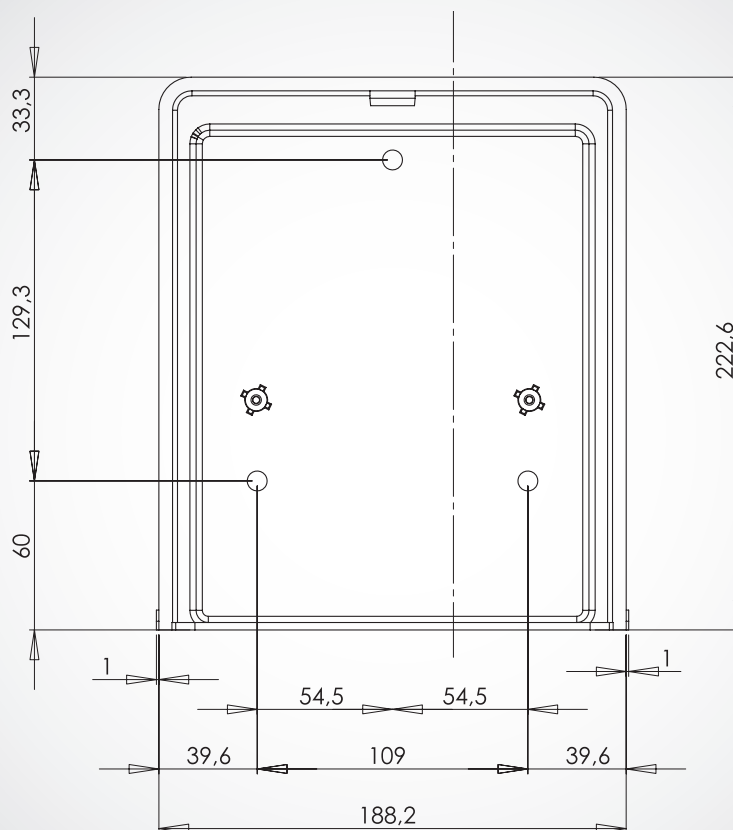

Wall installation

There is two optional choices; installing the unit directly on to a wall or installation with wall-bracket (accessory).

Fastening straight to wall

Remove parts as instructed on back to back installing. There are three marks for screws on the bottom. The bottom part is fastened on to wall surface with required type of screws. Installing plate is put back on place by placing the upper edge of installing plate on to the grooves of holder in bottom part and pushing the installing plate all the way down so that the pins on the bottom part are directed to holes in installing plate.

Fasten the plate B with M6x20 screws to the bottom part. After this follow the instruction of pole installation. Screw holes left open must be closed with screws (2pc).

Fastening with wall-bracket

Wall-bracket is fastened to wall with required type of screws and parts are removed as instructed in straight to wall installation. The bottom part and installing plate with accessories are fastened to wall-bracket with B-plate and four M6x20 screws.

Make sure that the attachment of installing plate and bottom part are as in pole installing. Following installation is made as in pole installation. Screw holes M6 left open must be closed with screws (2 pc).

NOTE! Use of lubricants is prohibited.

Accessories and spare parts

SSTL	PRODUCT	TYPE
3223761	Circuit breaker	5SJ6116-7
3261119	RCD resident current device	5SM1312-6
3405069	Hinge knob	580030
3408500	Lock+2 Euro-lock keys	580053
3405073	Lock+2 Euro-lock SS4keys	580050
3408510	Key Euro-lock	580057
3405030	Key Abloy SS3	580060
3405093	Key Abloy SS4	580061
3405075	Car heating and charging unit, empty 300-series	8MMO300T
3403114	Car heating and charging unit, empty 200-series	8MMO901
3431100	Car heating and charging unit, empty 400-serie, no lock	8MMO401
3431106	Car heating and charging unit, empty 400-series with lock	8MMO402
3431101	Car heating and charging unit back part 400-series	588011
3431102	Car heating and charging unit enclosure part 400-series	588012
3431103	Car heating and charging unit roof 400-series no lock	588013
3408515	Car heating and charging unit roof 400-series lock hole	580014
3405067	Car heating and charging unit roof 200-serie	580020
3405096	Wall fastening bracket	581400
3408506	Wall fastening bracket	8MMO300SLK
3408507	Connection pole for two wall fastening brackets	588043
3408508	Car heating and charging unit pole, black	588044
3405097	Tube plate	8MMO904
3431107	Electrical shock protection 458, 459, 468, 469	581327
3431108	Electrical shock protection 451, 452	581328
3408509	Led-lightning unit 300-series	588047
3405055	Clock and switch	8MMO906
3671596	Grässlin switching clock	582090
3571934	Theben clock AT1 (400-serie)	582091
3571935	Theben clock AT2 lighted (400-serie)	582092
2615800	Theben digital switching clock 2-channels	582094

Sammontie 9, 28400 ULVILA Finland
Tel. +358 2 5379 800
Fax +358 2 5379 810
www.satmatic.fi
piharasiat@satmatic.fi

