

Power distribution

MULTI-CUBICLE-TYPE ASSEMBLY 8HRO (HESI) Modular switchgear and controlgear assembly system



Multi-cubicle-type assembly 8HRO is part of the comprehensive production of AS Harju Elekter Elektrotehnika

For additional information we ask to make contact with AS Harju Elekter Elektrotehnika.

8HRO enables:

- To build 800 A main- and distribution switchboards
- Modular structure
- To build smaller and bigger distribution boards
- Type-tested modules
- Simple installation, operating and maintenance
- High degree of protection and safety

MULTI-CUBICLE-TYPE ASSEMBLY 8HRO (HESI)

DESCRIPTION OF MULTI-CUBICLE-TYPE ASSEMBLY 8HRO

Multi-cubicle-type assemblies 8HRO are used in distribution networks, electrical construction- and industrial plants, infrastructure and in public buildings as main- or distribution switchboards. Assemblies can be used for energy measurement, distribution, commutating and protecting lighting groups and power consumers. System is used in all cases where emphasis is placed on a high degree of availability in operation and extra protection of personnel and plant. Multi-cubicle-type assembly system 8HRO includes various enclosure sizes in height and width. Switchboards can be installed as surface mounted or floor standing.

CONSTRUCTION

Multi-cubicle-type assembly parts are manufactured to ensure high corrosion resistance from hot-dip galvanized steel sheet, which thickness varies in different parts from 1,25 mm to 2,0 mm. Doors are coated with powder painting (pebble grey RAL 7032). Switchgear and controlgear are installed on mounting plates or DIN-rails. Cable connections can be made from top or bottom.

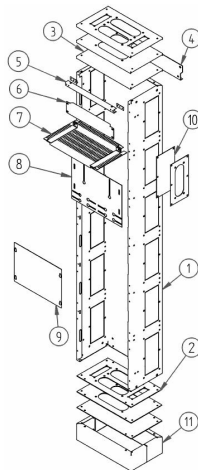

Example of 8HRO assembly's supporting structure :

- 1 – frame
- 2 – bottom plates
- 3 – roofs
- 4 – wall mount
- 5 – partition bar
- 6 – mounting bar
- 7 – partition plate
- 8 – mounting plate for energy meters
- 9 – mounting plate
- 10 – partition wall cover
- 11 – socket

MULTI-CUBICLE-TYPE ASSEMBLY'S 8HRO FUNCTIONAL PARTS

Multi-cubicle-type assembly's 8HRO steel sheet parts have the following functions:

- 8HRO supporting structure – for fixing mounting plates;
- 8HRO mounting plates – for fixing switchgear and controlgear;
- 8HRO doors and walls – for prevention of accidents, switchgear and controlgear installation;
- 8HRO roofs and bottom plates - for prevention of accidents and fixing flanges;
- 8HRO partition bars – to form sub-sections;
- 8HRO wall mounts – for surface mounting;
- 8HRO socket, covers etc.

MULTI-CUBICLE-TYPE ASSEMBLY 8HRO (HESI)

TECHNICAL INFORMATION

Rated frequency	f	50/60 Hz
Rated voltage (max)	U_e	400 V
Rated insulation voltage		$U_i=U_e$
Rated current (max)	I_n	800 A
Rated short-time withstand current (max)	I_{cw}	25 kA
Rated peak withstand current (max)	I_{pk}	52,5 kA
Degree of protection (EN 60529)		IP20 – IP44
Protection class against electric shock	I	
Number of poles		3/N/PE
Dimensions, mm	Height (without socket)	600 - 2100 mm
	Width	400 and 600 mm
	Cable canal	200 mm
	Depth	250 mm
Socket's height		100 mm
Internal separation		2 – 4
Functional units		Fixed parts
EMC Environment		1 and 2
Mechanical strength (EN 62262)		IK08
Installation method		Surface mounting
		Floor standing

MODULAR SYSTEM

8HRO enclosures can consist either of one section only or several modules and spaces. The modules are available in three widths (200, 400 and 600 mm) and six heights (600, 900, 1200, 1500, 1800 and 2100 mm), which enables to build different kind of assemblies according to customers needs.

STANDARDS

Multi-cubicle-type assembly 8HRO complies with standards EVS-EN 60439-1, EVS-EN 60439-3, SFS 2529:2000 and SFS 5601:2000.

CE MARKING ON 8HRO

CE Marking on a product is a manufacturer's declaration that the product complies with the essential requirements of the relevant European health, safety and environmental protection legislations and EU directives. It indicates to governmental officials that the product may be legally placed on the market in their country. CE Marking on a product ensures the free movement of the product within the EFTA & European Union (EU) single market, and permits the withdrawal of the non-conforming products by customs and enforcement/vigilance authorities.



MULTI-CUBICLE-TYPE ASSEMBLY 8HRO (HESI)

BOARDS FOR METERING AND DISTRIBUTION

Multi-cubicle-type assemblies 8HRO can be used for metering electric power consumption in 3-phase or single-phase systems. Energy meters readings can be viewed through a glass window. Assemblies can be used for commercial measurement or control measurement. To prevent access to unauthorized persons doors are equipped with a special key.

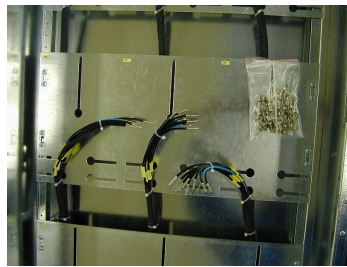

INTERNAL PROTECTION

To ensure IP20 degree of protection, when the door is opened, covers with firm connections are used, which prevent operating or maintenance personnel having access to live parts. Partition plates prevent loose parts and tools from falling between live parts.

INSTALLATION

Assemblies can be fixed to a wall with special wall mountings and to a floor with anchor bolts. Common fixing devices and screws can be used for surface mounting. Higher assemblies are equipped with lifting loops for transportation.

01/2006

As standards, specifications and design develop from time to time, manufacturer has right to change the specifications and design without announcement. Always ask AS Harju Elekter Elektrotehnika to check validity of data given in this publication.